

Sixth Form Open Evening 2023

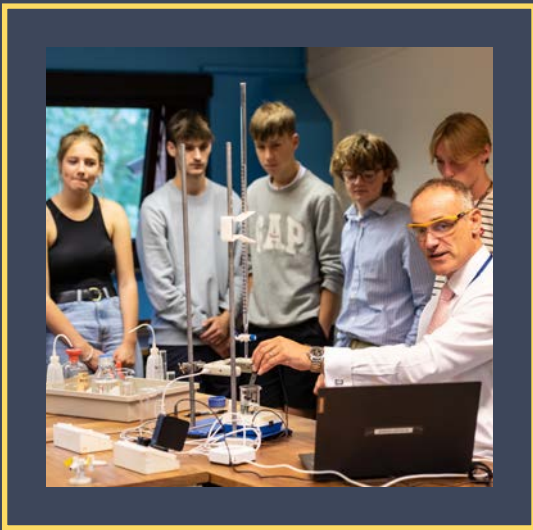



Welcome



Welcome to Wallingford School's Sixth Form Open Evening 2023.

Please talk to our students and staff, who will be very happy to offer more information about life at Wallingford School Sixth Form.

Each Taster Session will last for 15 minutes to allow time to move to the next session.

6.00pm	Welcome and register in the Sixth Form Common Room.
6.10pm	Talk 1 in the Hall for parents and students. If you have not been allocated Talk 1, please go straight to Taster Session 1.
6.10pm	Taster Session 1
6.30pm	Taster Session 2
6.50pm	Taster Session 3
7.10pm	Taster Session 4 / Talk 2 in the Hall for parents and students.
7.30pm	Taster Session 5
7.50 – 8:10pm	Staff will be available in the Main Hall to answer any questions.

Year 12 Options for 2023 Entry

Subject	Room
Applied Science - BTEC	W7
Art & Design - A Level and BTEC	Sixth Form Study Area
Art & Design: Fashion and Textiles - A Level	T5
Biology - A Level	W6
Business - BTEC	W12
Chemistry - A Level	W5
Drama & Theatre - A Level	K1
DT: Food Science and Nutrition - WJEC	T6
DT: Product Design - A Level	T2
English - A Level	W17
French & German - A Level	W18
Geography - A Level	W16
Health & Social Care - BTEC	W14
History - A Level	W2
Mathematics & Further Maths - A Level	W9
Media Studies - A Level	W13
Music - A Level	K2
Physical Education - A Level / Sport - BTEC	W15
Physics - A Level	W8
Politics - A Level	W3
Psychology - A Level	W11
Sociology - A Level	W1
Registration	Sixth Form Centre
Welcome Talks	Main Hall
Careers Advisor	Upstairs in W Block

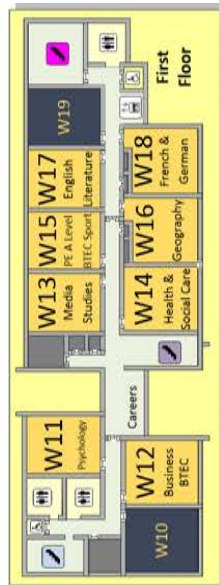
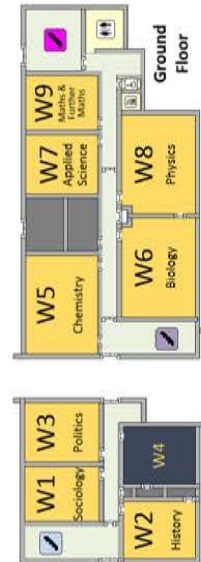
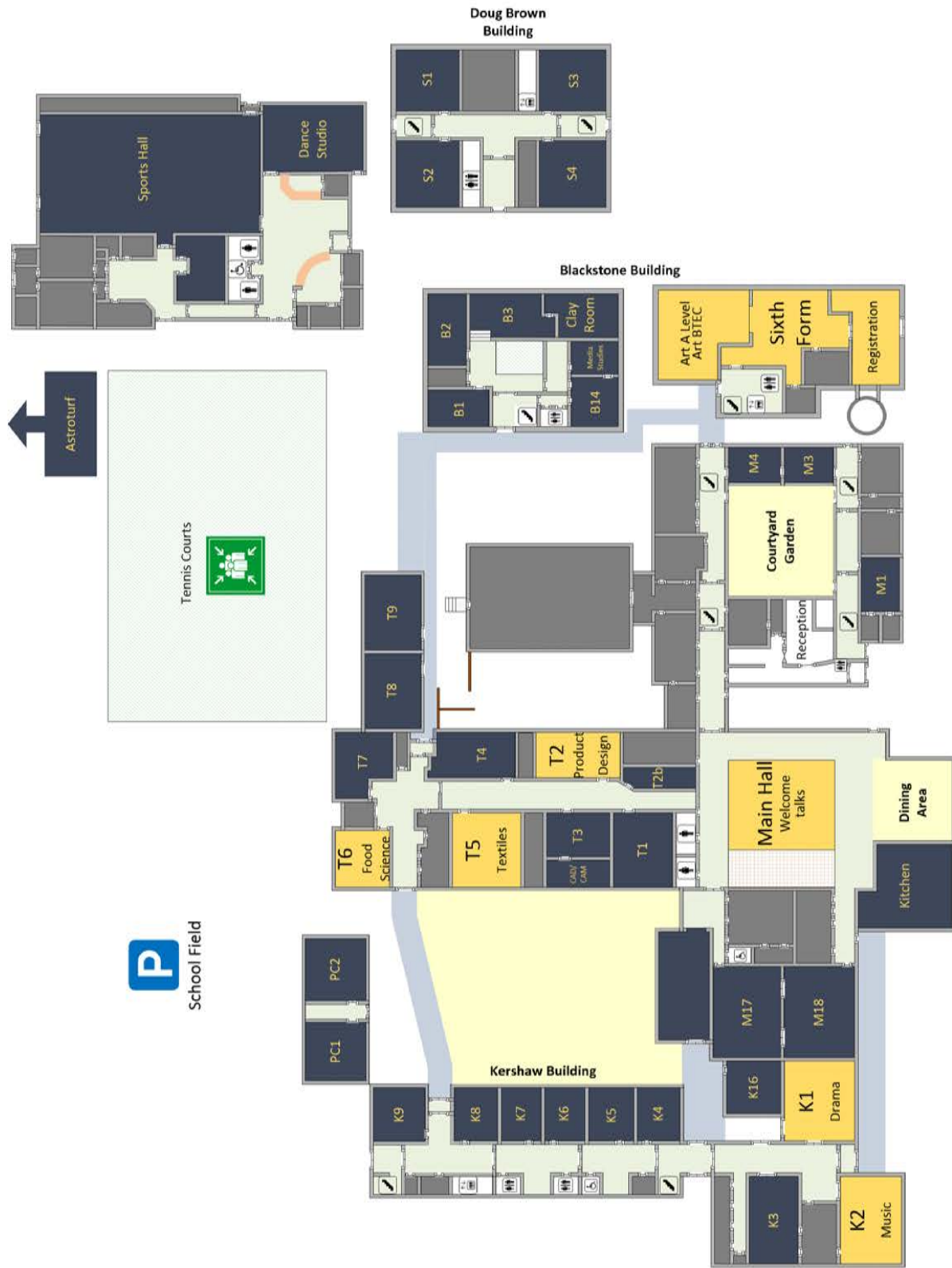



KS5 Results Day, August 2023

We are very proud of the Sixth Form at Wallingford where we offer a wide range of courses, high quality teaching and strong student support throughout the two years. Our results are outstanding and our value added puts us amongst the best schools in the country. Our Sixth Form enables students to access places on the most competitive university courses and apprenticeships whilst also providing two enriching years of opportunities and fun.

For the staff who work here it feels great to know we are still catering for the whole of our community and not selecting students. It is a privilege to work with some of the brightest academic students anywhere while ensuring we help those who need a different approach to make the next step in their lives.

The majority of our students progress to university places and we are very successful in getting large numbers into the more selective Russell Group universities. At the top end we have secured twelve Oxbridge, medicine and veterinary school offers in the last three years. As a very high-performing school, much of this is to do with securing top grades but we also take great care over the application process and ensure that the experience in Sixth Form here is about a lot more than what goes on in the classroom. We are keen to encourage young people to consider apprenticeships when they leave us, however impressive their profile of results. We are very traditional. Free periods are free only in the sense that young people get to study what they want in the Sixth Form study area. Beyond that we put a lot of resources into ensuring that there are many varied opportunities to develop as a character and enjoy each other's company, be it on activities we run in school or the high-profile trips that are so popular with staff and students. It is a welcoming, happy and very successful Sixth Form. We are extremely proud of it and hope you can appreciate why.



Year 12 Duke of Edinburgh Expedition



Wallingford School, St George's Road, Wallingford, Oxford, OX10 8HH
Website: www.wallingfordschool.com | Social Media: @wallingford4140